

HOTWAVE®

HEATED HOSE SPRAYER



Provides on demand heated water outdoors whenever and wherever it's needed! Safe and easy to use, HotWave gives you control of the water temperature, spray patterns, and water pressure. You can use it on tough jobs like cleaning outdoor furniture to more gentle jobs like washing the dog.



Pet Grooming



Outdoor Cleaning

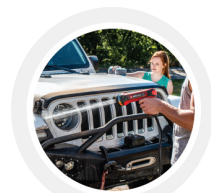

Car Washing



RV & Camping

PERFORMANCE FEATURES

ON DEMAND HEATED WATER OUTDOORS*

Adjustable water temperature and water pressure

* Temperature varies by zone. See Performance Guide.

USE ANYWHERE WITH A GARDEN HOSE AND ELECTRICAL OUTLET

25' cord with GFCI Protection, 120V, 15-AMP connection

SAFE AND EASY TO USE

Insulated, ergonomic grip handle with trigger and lock mechanism

4 SPRAY PATTERNS

Adjustable nozzle settings give you more control

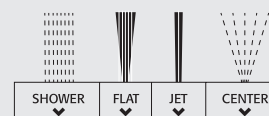

PRODUCT SPECIFICATIONS

Model Number	HTW018120
Max Power	1.8 kW
Amps / Volts	15 amps / 120V
Heating Element	Copper sheathed
Electrical Cord Length	25-feet
Water Hose Length	6-feet
Water Source	Potable Water
Water Pressure Min.	30 PSI
Water Pressure Max.	150 PSI
Water Connection	Standard 5/8" garden hose connection
Height x Width x Depth	7" x 3" x 10"
Weight	2.5 lb
Warranty	1-Year limited



This product meets a stringent set of our internally defined sustainability standards



Rheem.com



INCLUDES A POWER CORD
AND IS COMPATIBLE WITH
A STANDARD GARDEN HOSE

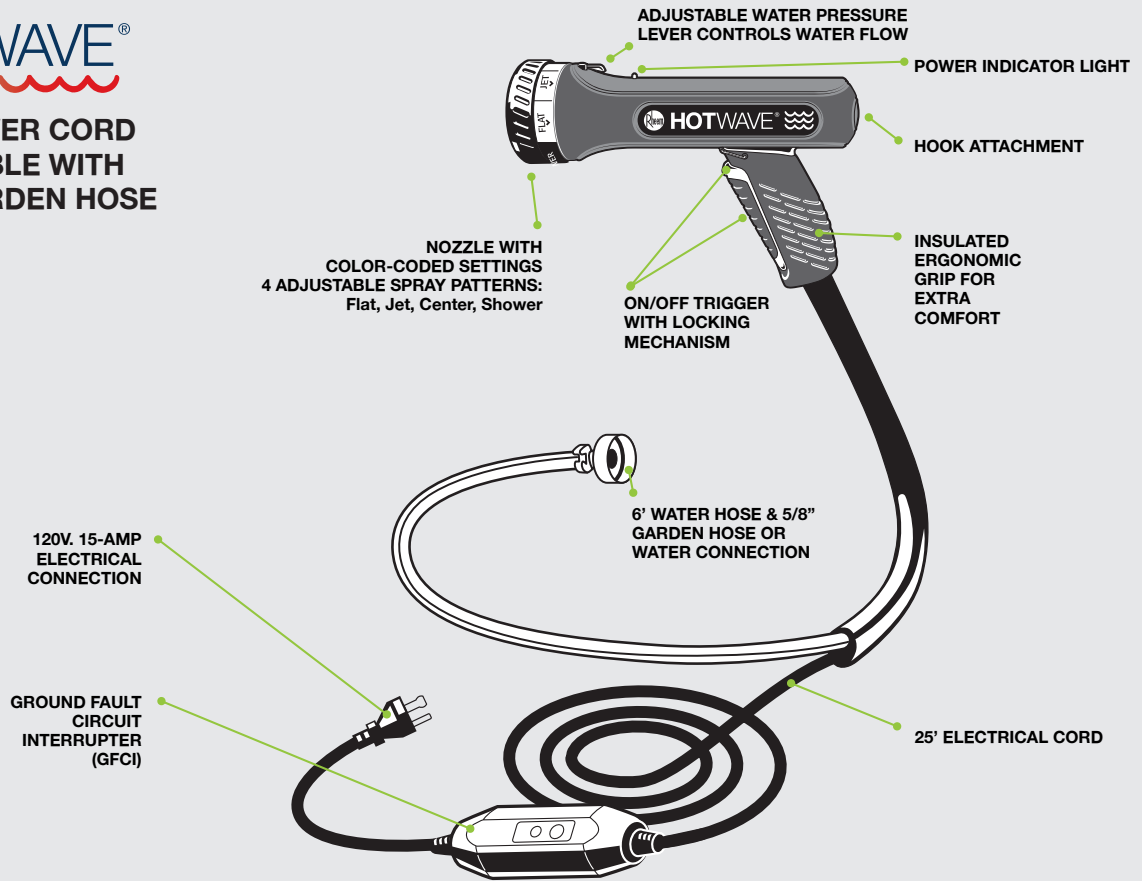

PERFORMANCE GUIDE

Your location's average ground water temperature and nozzle settings will affect the performance of Hotwave. Follow these 2 steps to confirm Hotwave meets your needs.

- 1 Use the U.S. Ground Water Temperature Map to locate your zone.

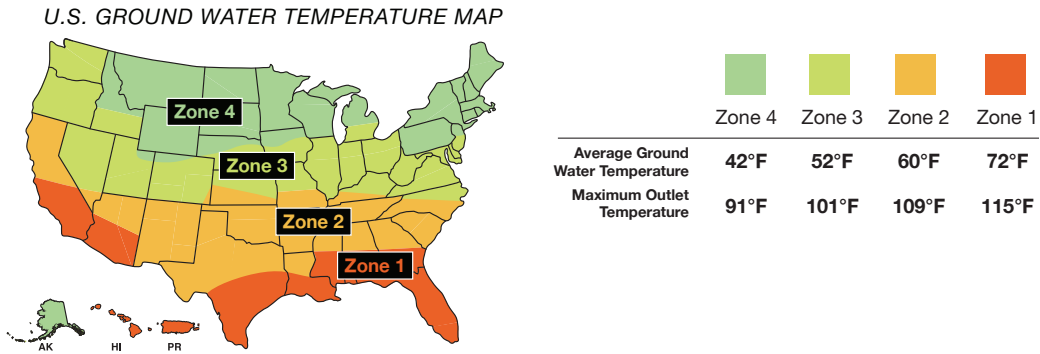

- 2 On the Performance Table, locate the corresponding zone row from Step 1. This row highlights the average outlet water temperature and flow rate (water pressure) by nozzle setting.

PERFORMANCE TABLE

Average Inlet Ground Water Temp.		Nozzle Settings								
		Flat, Jet, Shower		Flow Rate Range	Center, Flat, Jet		Flow Rate Range	Flat, Jet		Flow Rate Range
		Average Outlet Temp	GPM*	Average Outlet Temp	GPM*	Average Outlet Temp	GPM*			
Zone 1	72°F	84°F	0.3 - 1	102°F	0.25 - 0.4	115°F	0.2 - 0.25			
Zone 2	60°F	72°F	0.3 - 1	90°F	0.25 - 0.4	109°F	0.2 - 0.25			
Zone 3	52°F	64°F	0.3 - 1	82°F	0.25 - 0.4	101°F	0.2 - 0.25			
Zone 4	42°F	54°F	0.3 - 1	72°F	0.25 - 0.4	91°F	0.2 - 0.25			

*Gallons per minute
NOTES: 1. Temperatures displayed in the table are based on national averages, maximum outlet water temperature is 115°F and may vary +5°F/-10°F. 2. The table is directional and outlet temperatures will vary based on flow rate. 3. Temperature and Flow Rate Reference: 60°F considered cool, 72° considered room temperature and the average garden hose water flow rate is 9 GPM. 4. HotWave is not intended for use as a power or pressure washer. 5. The temperature rise (outlet temp-inlet temp = temp rise) for each nozzle setting: Blue- 12°F, Orange- 30°F and Red- 49°F.