

FAUCET AND DISPENSER

Enjoy instant filtered **cold** and **near-boiling hot** water



Model 2-1 Shown in
Brushed Nickel Finish

Model 4-1 Shown in
Chrome Finish

Save time and effort with everything from cooking to simply relaxing with a hot cup of tea.

Made to seamlessly fit into an existing kitchen setup and available either as a faucet or a dispenser, the XpressHot™ ensures that there will always be both filtered cold and near-boiling hot water available for tea, soup and more.

FEATURES

- Filtered cold water
- Filtered near-boiling* hot water
- Two available finishes seamlessly integrate into the kitchen décor
- Safety features on both models for safe use around children
- Hot / cold indicator light
- Tee-connector and braided hose included
- Created using direct feedback from customers
- Intuitive digital display that shows diagnostics, ECO mode and when filter needs to be replaced
- Two filters included to equal up to a year's worth of filters
- Lead-free components for added safety

USES

- Reduce water usage
- Make instant soups and cereals
- Brew the perfect cup of hot tea or French press coffee
- Fill a water bottle with filtered water right from the tap
- Soak baked-on food for easy removal from dishes
- Sanitize dishes
- And so much more!

*XpressHot heats water up to 208°F (98°C). Water boils at 212°F (100°C).

**Tested install time on field test installs. Install time does not include removing the existing faucet or soap dispenser. Does not include install time of the electrical outlet if needed for the specific application.

BASE UNIT DIMENSIONS

13.7" H x 8.25" W x 8.25" D
(348mm H x 210mm W x 210mm D)

HOW IT WORKS

- XpressHot provides instant hot water on demand, so waiting for water to boil is a thing of the past.
- Easy to set up and integrate into your kitchen, either as a replacement for the kitchen faucet (Model 4-1) or simply installed into the existing soap dispenser location (Model 2-1).
- The 120V wall outlet powering the dispenser must have power supplied to it continuously.
- The garbage disposal outlet CANNOT be used without the addition of an air switch to control the disposal.

BASE UNIT INSTALLATION DIAGRAMS

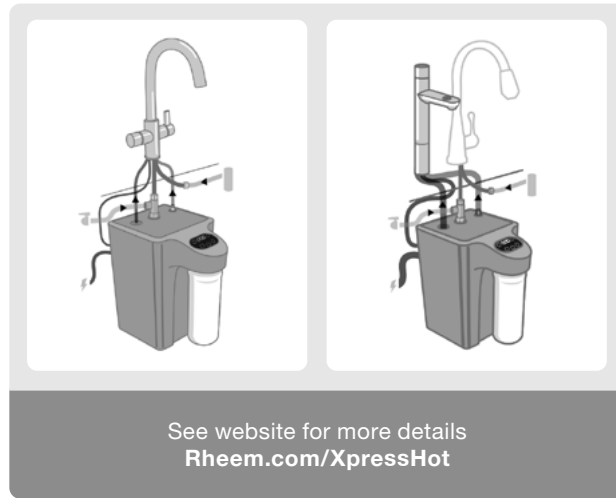

SPECIFICATIONS

Voltage:	120V, plugs into a standard dedicated outlet
Watts:	1100W
Amps:	9A
Frequency:	60Hz
Phase:	Single
Required circuit breaker:	15A
Faucet type:	Electronically operated filtered hot / cold dispenser with safety lock
Dispenser type:	Electronically operated filtered hot / cold dispenser with safety lock / lever-operated hot cold
Faucet flow rate:	1.5 GPM (5.7 LPM)
Dispenser flow rate:	0.15–0.2 GPM (0.57–0.76 LPM)
Water connection:	Top of the base unit, 1/2" (12.7mm) compression fitting
Tank capacity:	0.66 gallons (2.5 liters)
Recovery time from startup:	8–10 minutes from point of install
Max. output per hour:	64 cups (15 liters)
Min. and max. working pressure:	30 PSI and 150 PSI
Min. and max. operating temp:	168°F (75°C) and 208°F (98°C)

FAQS

- **How hot does the water get?** Unit will heat to the set point, ranging from 168°F (75°C) to 208°F (98°C).
- **What are the electric requirements for installation?** The wall outlet the base unit plugs into must have a continuous power supply and be fused. It should not be controlled by the same wall switch that operates your disposal. If it is controlled by the same wall switch, it's required that you purchase an adapter such as a wireless switch or air switch to control the disposal, and leave the wall switch turned on.
- **Can I use this for cold water too?** Yes. Water temp will be the same temp as cold tap water, but filtered.
- **Is this child-safe?** Yes, there is a safety mechanism for dispensing near-boiling hot water.
 - Dispenser version has a child safety lock in which you need to press the unlock button and then the dispense button.
 - Faucet version has a selection switch for hot/cold/lock, which needs to be rotated to hot, followed by holding the dispense button for 3 seconds.
- **Is this product safe?** This product complies with UL and CUL safety standards.
- **Explain application options:** Filtered hot water can be used for hot tea and cereal, for speeding up the boiling process when cooking and for anything else that requires hot water. Filtered cold water can be used for drinking, cooking or anything else that requires fresh, delicious water.
- **How long is the electric cord?** 37" (940 mm)
- **Does XpressHot come with a warranty?** 1-Year Tank & Parts

